

SY0-701 Dumps

CompTIA Security+ Exam

<https://www.certleader.com/SY0-701-dumps.html>



NEW QUESTION 1

- (Exam Topic 1)

A software company is analyzing a process that detects software vulnerabilities at the earliest stage possible. The goal is to scan the source looking for unsecure practices and weaknesses before the application is deployed in a runtime environment. Which of the following would BEST assist the company with this objective?

- A. Use fuzzing testing
- B. Use a web vulnerability scanner
- C. Use static code analysis
- D. Use a penetration-testing OS

Answer: C

Explanation:

Using static code analysis would be the best approach to scan the source code looking for unsecure practices and weaknesses before the application is deployed in a runtime environment. This method involves analyzing the source code without actually running the software, which can identify security vulnerabilities that may not be detected by other testing methods. References: CompTIA Security+ Study Guide, Exam SY0-601, 4th Edition, Chapter 6: Risk Management, pp. 292-295

NEW QUESTION 2

- (Exam Topic 1)

A security analyst needs to implement an MDM solution for BYOD users that will allow the company to retain control over company emails residing on the devices and limit data exfiltration that might occur if the devices are lost or stolen. Which of the following would BEST meet these requirements? (Select TWO).

- A. Full-device encryption
- B. Network usage rules
- C. Geofencing
- D. Containerization
- E. Application whitelisting
- F. Remote control

Answer: DE

Explanation:

MDM solutions emerged to solve problems created by BYOD. With MDM, IT teams can remotely wipe devices clean if they are lost or stolen. MDM also makes the life of an IT administrator a lot easier as it allows them to enforce corporate policies, apply software updates, and even ensure that password protection is used on each device. Containerization and application whitelisting are two features of MDM that can help retain control over company emails residing on the devices and limit data exfiltration that might occur if the devices are lost or stolen.

Containerization is a technique that creates a separate and secure space on the device for work-related data and applications. This way, personal and corporate data are isolated from each other, and IT admins can manage only the work container without affecting the user's privacy. Containerization also allows IT admins to remotely wipe only the work container if needed, leaving the personal data intact.

Application whitelisting is a technique that allows only authorized applications to run on the device. This way, IT admins can prevent users from installing or using malicious or unapproved applications that might compromise the security of corporate data. Application whitelisting also allows IT admins to control which applications can access corporate resources, such as email servers or cloud storage.

References: <https://www.comptia.org/certifications/security#examdetails> <https://www.comptia.org/content/guides/comptia-security-sy0-601-exam-objectives>
<https://www.office1.com/blog/byod-vs-mdm>

NEW QUESTION 3

- (Exam Topic 1)

A company is planning to install a guest wireless network so visitors will be able to access the Internet. The stakeholders want the network to be easy to connect to so time is not wasted during meetings. The WAPs are configured so that power levels and antennas cover only the conference rooms where visitors will attend meetings. Which of the following would BEST protect the company's internal wireless network against visitors accessing company resources?

- A. Configure the guest wireless network to be on a separate VLAN from the company's internal wireless network
- B. Change the password for the guest wireless network every month.
- C. Decrease the power levels of the access points for the guest wireless network.
- D. Enable WPA2 using 802.1X for logging on to the guest wireless network.

Answer: A

Explanation:

Configuring the guest wireless network on a separate VLAN from the company's internal wireless network will prevent visitors from accessing company resources. References: CompTIA Security+ Study Guide: Exam SY0-601, Chapter 4

NEW QUESTION 4

- (Exam Topic 1)

A security engineer is installing a WAF to protect the company's website from malicious web requests over SSL. Which of the following is needed to meet the objective?

- A. A reverse proxy
- B. A decryption certificate
- C. A spill-tunnel VPN
- D. Load-balanced servers

Answer: B

Explanation:

A Web Application Firewall (WAF) is a security solution that protects web applications from various types of attacks such as SQL injection, cross-site scripting (XSS), and others. It is typically deployed in front of web servers to inspect incoming traffic and filter out malicious requests.

To protect the company's website from malicious web requests over SSL, a decryption certificate is needed to decrypt the SSL traffic before it reaches the WAF.

This allows the WAF to inspect the traffic and filter out malicious requests.

NEW QUESTION 5

- (Exam Topic 1)

As part of annual audit requirements, the security team performed a review of exceptions to the company policy that allows specific users the ability to use USB storage devices on their laptops. The review yielded the following results.

- The exception process and policy have been correctly followed by the majority of users
- A small number of users did not create tickets for the requests but were granted access
- All access had been approved by supervisors.
- Valid requests for the access sporadically occurred across multiple departments.
- Access, in most cases, had not been removed when it was no longer needed

Which of the following should the company do to ensure that appropriate access is not disrupted but unneeded access is removed in a reasonable time frame?

- A. Create an automated, monthly attestation process that removes access if an employee's supervisor denies the approval
- B. Remove access for all employees and only allow new access to be granted if the employee's supervisor approves the request
- C. Perform a quarterly audit of all user accounts that have been granted access and verify the exceptions with the management team
- D. Implement a ticketing system that tracks each request and generates reports listing which employees actively use USB storage devices

Answer: A

Explanation:

According to the CompTIA Security+ SY0-601 documents, the correct answer option is A. Create an automated, monthly attestation process that removes access if an employee's supervisor denies the approval¹².

This option ensures that appropriate access is not disrupted but unneeded access is removed in a reasonable time frame by requiring supervisors to approve or deny the exceptions on a regular basis. It also reduces the manual workload of the security team and improves the compliance with the company policy.

NEW QUESTION 6

- (Exam Topic 1)

A store receives reports that shoppers' credit card information is being stolen. Upon further analysis, those same shoppers also withdrew money from an ATM in that store.

The attackers are using the targeted shoppers' credit card information to make online purchases. Which of the following attacks is the MOST probable cause?

- A. Identity theft
- B. RFID cloning
- C. Shoulder surfing
- D. Card skimming

Answer: D

Explanation:

The attackers are using card skimming to steal shoppers' credit card information, which they use to make online purchases. References:

➤ [CompTIA Security+ Study Guide Exam SY0-601, Chapter 5](#)

NEW QUESTION 7

- (Exam Topic 1)

A retail company that is launching @ new website to showcase the company's product line and other information for online shoppers registered the following URLs:

- * www.companysite.com
- * shop.companysite.com
- * about-us.companysite.com
- * contact-us.companysite.com
- * secure-login.companysite.com

Which of the following should the company use to secure its website if the company is concerned with convenience and cost?

- A. A self-signed certificate
- B. A root certificate
- C. A code-signing certificate
- D. A wildcard certificate
- E. An extended validation certificate

Answer: D

Explanation:

The company can use a wildcard certificate to secure its website if it is concerned with convenience and cost. A wildcard certificate can secure multiple subdomains, which makes it cost-effective and convenient for securing the various registered domains.

The retail company should use a wildcard certificate if it is concerned with convenience and cost. A wildcard SSL certificate is a single SSL/TLS certificate that can provide significant time and cost savings, particularly for small businesses. The certificate includes a wildcard character (*) in the domain name field, and can secure multiple subdomains of the primary domain¹

NEW QUESTION 8

- (Exam Topic 1)

After gaining access to a dual-homed (i.e., wired and wireless) multifunction device by exploiting a vulnerability in the device's firmware, a penetration tester then gains shell access on another networked asset. This technique is an example of:

- A. privilege escalation
- B. footprinting
- C. persistence
- D. pivoting.

Answer: D

Explanation:

The technique of gaining access to a dual-homed multifunction device and then gaining shell access on another networked asset is an example of pivoting. References: CompTIA Security+ Study Guide by Emmett Dulaney, Chapter 8: Application, Data, and Host Security, Enumeration and Penetration Testing

NEW QUESTION 9

- (Exam Topic 1)

The Chief information Security Officer has directed the security and networking team to retire the use of shared passwords on routers and switches. Which of the following choices BEST meets the requirements?

- A. SAML
- B. TACACS+
- C. Password vaults
- D. OAuth

Answer: B

Explanation:

TACACS+ is a protocol used for remote authentication, authorization, and accounting (AAA) that can be used to replace shared passwords on routers and switches. It provides a more secure method of authentication that allows for centralized management of access control policies. References: CompTIA Security+ Study Guide, Exam SY0-601, 4th Edition, Chapter 6

NEW QUESTION 10

- (Exam Topic 1)

A security administrator wants to implement a program that tests a user's ability to recognize attacks over the organization's email system Which of the following would be BEST suited for this task?

- A. Social media analysis
- B. Annual information security training
- C. Gamification
- D. Phishing campaign

Answer: D

Explanation:

A phishing campaign is a simulated attack that tests a user's ability to recognize attacks over the organization's email system. Phishing campaigns can be used to train users on how to identify and report suspicious emails.

References: CompTIA Security+ Study Guide, Exam SY0-601, 4th Edition, Chapter 2: Technologies and Tools, pp. 85-86.

NEW QUESTION 10

- (Exam Topic 1)

A company recently decided to allow its employees to use their personally owned devices for tasks like checking email and messaging via mobile applications. The company would like to use MDM, but employees are concerned about the loss of personal data. Which of the following should the IT department implement to BEST protect the company against company data loss while still addressing the employees' concerns?

- A. Enable the remote-wiping option in the MDM software in case the phone is stolen.
- B. Configure the MDM software to enforce the use of PINs to access the phone.
- C. Configure MDM for FDE without enabling the lock screen.
- D. Perform a factory reset on the phone before installing the company's applications.

Answer: C

Explanation:

MDM software is a type of remote asset-management software that runs from a central server. It is used by businesses to optimize the functionality and security of their mobile devices, including smartphones and tablets. It can monitor and regulate both corporate-owned and personally owned devices to the organization's policies.

FDE stands for full disk encryption, which is a method of encrypting all data on a device's storage. FDE can protect data from unauthorized access in case the device is lost or stolen.

If a company decides to allow its employees to use their personally owned devices for work tasks, it should configure MDM software to enforce FDE on those devices. This way, the company can protect its data from being exposed if the device falls into the wrong hands.

However, employees may be concerned about the loss of personal data if the company also enables the remote-wiping option in the MDM software. Remote wiping is a feature that allows the company to erase all data on a device remotely in case of theft or loss. Remote wiping can also affect personal data on the device, which may not be acceptable to employees.

Therefore, a possible compromise is to configure MDM for FDE without enabling the lock screen. This means that the device will be encrypted, but it will not require a password or PIN to unlock it. This way, employees can access their personal data easily, while the company can still protect its data with encryption. The other options are not correct because:

- A. Enable the remote-wiping option in the MDM software in case the phone is stolen. This option may address the company's concern about data loss, but it may not address the employees' concern about personal data loss. Remote wiping can erase both work and personal data on the device, which may not be desirable for employees.
- B. Configure the MDM software to enforce the use of PINs to access the phone. This option may enhance the security of the device, but it may not address the company's concern about data loss. PINs can be guessed or bypassed by attackers, and they do not protect data if the device is physically accessed.
- D. Perform a factory reset on the phone before installing the company's applications. This option may address the company's concern about data loss, but it may not address the employees' concern about personal data loss. A factory reset will erase all data on the device, including personal data, which may not be acceptable to employees.

According to CompTIA Security+ SY0-601 Exam Objectives 2.4 Given a scenario, implement secure systems design:

"MDM software is a type of remote asset-management software that runs from a central server1. It is used by businesses to optimize the functionality and security of their mobile devices, including smartphones and tablets2."

"FDE stands for full disk encryption, which is a method of encrypting all data on a device's storage3." References:

<https://www.comptia.org/certifications/security#examdetails>

<https://www.comptia.org/content/guides/comptia-security-sy0-601-exam-objectives>

<https://www.makeuseof.com/what-is-mobile-device-management-mdm-software/>

NEW QUESTION 15

- (Exam Topic 1)

A cybersecurity administrator needs to implement a Layer 7 security control on a network and block potential attacks. Which of the following can block an attack at Layer 7? (Select TWO).

- A. HIDS
- B. NIPS
- C. HSM
- D. WAF
- E. NAC
- F. NIDS
- G. Stateless firewall

Answer: DF

Explanation:

A WAF (Web Application Firewall) and NIDS (Network Intrusion Detection System) are both examples of Layer 7 security controls. A WAF can block attacks at the application layer (Layer 7) of the OSI model by filtering traffic to and from a web server. NIDS can also detect attacks at Layer 7 by monitoring network traffic for suspicious patterns and behaviors. References: CompTIA Security+ Study Guide, pages 94-95, 116-118

NEW QUESTION 19

- (Exam Topic 1)

Which of the following is a physical security control that ensures only the authorized user is present when gaining access to a secured area?

- A. A biometric scanner
- B. A smart card reader
- C. APKItoken
- D. A PIN pad

Answer: A

Explanation:

A biometric scanner uses physical characteristics such as fingerprints to identify an individual user. It is used to ensure that only the authorized user is present when gaining access to a secured area.

NEW QUESTION 22

- (Exam Topic 1)

A security administrator has discovered that workstations on the LAN are becoming infected with malware.

The cause of the infections appears to be users receiving phishing emails that are bypassing the current email-filtering technology. As a result, users are being tricked into clicking on malicious URLs, as no internal controls currently exist in the environment to evaluate their safety. Which of the following would be BEST to implement to address the issue?

- A. Forward proxy
- B. HIDS
- C. Awareness training
- D. A jump server
- E. IPS

Answer: C

Explanation:

Awareness training should be implemented to educate users on the risks of clicking on malicious URLs. References: CompTIA Security+ Study Guide: Exam SY0-601, Chapter 9

NEW QUESTION 26

- (Exam Topic 1)

A company uses a drone for precise perimeter and boundary monitoring. Which of the following should be MOST concerning to the company?

- A. Privacy
- B. Cloud storage of telemetry data
- C. GPS spoofing
- D. Weather events

Answer: A

Explanation:

The use of a drone for perimeter and boundary monitoring can raise privacy concerns, as it may capture video and images of individuals on or near the monitored premises. The company should take measures to ensure that privacy rights are not violated. References:

➤ CompTIA Security+ Study Guide, Exam SY0-601, 4th Edition, Chapter 8

NEW QUESTION 29

- (Exam Topic 1)

Which of the following BEST describes a technique that compensates researchers for finding vulnerabilities?

- A. Penetration testing

- B. Code review
- C. Wardriving
- D. Bug bounty

Answer: D

Explanation:

A bug bounty is a technique that compensates researchers for finding vulnerabilities in software or systems. A bug bounty program is an initiative that offers rewards, usually monetary, to ethical hackers who report security flaws to the owners or developers of the software or system. Bug bounty programs are often used by companies such as Meta (formerly Facebook), Google, Microsoft, and others to improve the security of their products and services. Bug bounty programs compensate researchers, often financially, for finding vulnerabilities in software, websites, or other technology. These programs provide an additional layer of security testing and incentivize researchers to report vulnerabilities instead of exploiting them.

NEW QUESTION 33

- (Exam Topic 1)

A systems analyst determines the source of a high number of connections to a web server that were initiated by ten different IP addresses that belong to a network block in a specific country. Which of the following techniques will the systems analyst MOST likely implement to address this issue?

- A. Content filter
- B. SIEM
- C. Firewall rules
- D. DLP

Answer: C

Explanation:

A firewall is a network security system that monitors and controls incoming and outgoing network traffic based on predetermined security rules. The systems analyst can use firewall rules to block connections from the ten IP addresses in question, or from the entire network block in the specific country. This would be a quick and effective way to address the issue of high connections to the web server initiated by these IP addresses.

Reference: CompTIA Security+ SY0-601 Official Text Book, Chapter 5: "Network Security".

NEW QUESTION 37

- (Exam Topic 1)

An organization discovered a disgruntled employee exfiltrated a large amount of PII data by uploading files. Which of the following controls should the organization consider to mitigate this risk?

- A. EDR
- B. Firewall
- C. HIPS
- D. DLP

Answer: D

Explanation:

DLP stands for data loss prevention, which is a set of tools and processes that aim to prevent unauthorized access, use, or transfer of sensitive data. DLP can help mitigate the risk of data exfiltration by disgruntled employees or external attackers by monitoring and controlling data flows across endpoints, networks, and cloud services. DLP can also detect and block attempts to copy, print, email, upload, or download sensitive data based on predefined policies and rules.

References: <https://www.comptia.org/certifications/security#examdetails> <https://www.comptia.org/content/guides/comptia-security-sy0-601-exam-objectives> <https://www.forcepoint.com/cyber-edu/data-loss-prevention-dlp>

NEW QUESTION 42

- (Exam Topic 1)

A company acquired several other small companies. The company that acquired the others is transitioning network services to the cloud. The company wants to make sure that performance and security remain intact. Which of the following BEST meets both requirements?

- A. High availability
- B. Application security
- C. Segmentation
- D. Integration and auditing

Answer: A

Explanation:

High availability refers to the ability of a system or service to remain operational and available to users with minimal downtime. By ensuring high availability, the company can maintain good performance and ensure that users have access to the network services they need. High availability can also improve security, as it helps to prevent disruptions that could potentially be caused by security incidents or other issues.

NEW QUESTION 47

- (Exam Topic 1)

A company installed several crosscut shredders as part of increased information security practices targeting data leakage risks. Which of the following will this practice reduce?

- A. Dumpster diving
- B. Shoulder surfing
- C. Information elicitation
- D. Credential harvesting

Answer: A

Explanation:

Crosscut shredders are used to destroy paper documents and reduce the risk of data leakage through dumpster diving. Dumpster diving is a method of retrieving sensitive information from paper waste by searching through discarded documents.

References:

➤ CompTIA Security+ Study Guide, Exam SY0-601, 4th Edition, Chapter 2

NEW QUESTION 49

- (Exam Topic 1)

An enterprise needs to keep cryptographic keys in a safe manner. Which of the following network appliances can achieve this goal?

- A. HSM
- B. CASB
- C. TPM
- D. DLP

Answer: A

Explanation:

Hardware Security Module (HSM) is a network appliance designed to securely store cryptographic keys and perform cryptographic operations. HSMs provide a secure environment for key management and can be used to keep cryptographic keys safe from theft, loss, or unauthorized access. Therefore, an enterprise can achieve the goal of keeping cryptographic keys in a safe manner by using an HSM appliance. References: CompTIA Security+ Certification Exam Objectives, Exam Domain 2.0: Technologies and Tools, 2.4 Given a scenario, use appropriate tools and techniques to troubleshoot security issues, p. 21

NEW QUESTION 51

- (Exam Topic 1)

The Chief Information Security Officer wants to pilot a new adaptive, user-based authentication method. The concept Includes granting logical access based on physical location and proximity. Which of the following Is the BEST solution for the pilot?

- A. Geofencing
- B. Self-sovereign identification
- C. PKI certificates
- D. SSO

Answer: A

Explanation:

Geofencing is a location-based technology that allows an organization to define and enforce logical access control policies based on physical location and proximity. Geofencing can be used to grant or restrict access to systems, data, or facilities based on an individual's location, and it can be integrated into a user's device or the infrastructure. This makes it a suitable solution for the pilot project to test the adaptive, user-based authentication method that includes granting logical access based on physical location and proximity.

Reference: CompTIA Security+ SY0-601 Official Text Book, Chapter 4: "Identity and Access Management".

NEW QUESTION 54

- (Exam Topic 1)

An information security manager for an organization is completing a PCI DSS self-assessment for the first time. which of the is following MOST likely reason for this type of assessment?

- A. An international expansion project is currently underway.
- B. Outside consultants utilize this tool to measure security maturity.
- C. The organization is expecting to process credit card information.
- D. A government regulator has requested this audit to be completed

Answer: C

Explanation:

PCI DSS (Payment Card Industry Data Security Standard) is a set of security standards designed to ensure that all companies that accept, process, store, or transmit credit card information maintain a secure environment. Any organization that accepts credit card payments is required to comply with PCI DSS.

NEW QUESTION 58

- (Exam Topic 1)

A security analyst is running a vulnerability scan to check for missing patches during a suspected security rodent During which of the following phases of the response process is this activity MOST likely occurring?

- A. Containment
- B. Identification
- C. Recovery
- D. Preparation

Answer: B

Explanation:

Vulnerability scanning is a proactive security measure used to identify vulnerabilities in the network and systems. References: CompTIA Security+ Study Guide 601, Chapter 4

NEW QUESTION 63

- (Exam Topic 1)

A security engineer is installing a WAF to protect the company's website from malicious web requests over SSL. Which of the following is needed to meet the

objective?

- A. A reverse proxy
- B. A decryption certificate
- C. A split-tunnel VPN
- D. Load-balanced servers

Answer: B

Explanation:

A Web Application Firewall (WAF) is a security solution that protects web applications from various types of attacks such as SQL injection, cross-site scripting (XSS), and others. It is typically deployed in front of web servers to inspect incoming traffic and filter out malicious requests.

To protect the company's website from malicious web requests over SSL, a decryption certificate is needed to decrypt the SSL traffic before it reaches the WAF. This allows the WAF to inspect the traffic and filter out malicious requests.

NEW QUESTION 67

- (Exam Topic 1)

Ann, a customer, received a notification from her mortgage company stating her PII may be shared with partners, affiliates, and associates to maintain day-to-day business operations.

Which of the following documents did Ann receive?

- A. An annual privacy notice
- B. A non-disclosure agreement
- C. A privileged-user agreement
- D. A memorandum of understanding

Answer: A

Explanation:

Ann received an annual privacy notice from her mortgage company. An annual privacy notice is a statement from a financial institution or creditor that outlines the institution's privacy policy and explains how the institution collects, uses, and shares customers' personal information. It informs the customer about their rights under the Gramm-Leach-Bliley Act (GLBA) and the institution's practices for protecting their personal information. References:

➤ [CompTIA Security+ Certification Exam Objectives - Exam SY0-601](#)

NEW QUESTION 68

- (Exam Topic 1)

A security researcher is using an adversary's infrastructure and TTPs and creating a named group to track those targeted Which of the following is the researcher MOST likely using?

- A. The Cyber Kill Chain
- B. The incident response process
- C. The Diamond Model of Intrusion Analysis
- D. MITRE ATT&CK

Answer: D

Explanation:

The researcher is most likely using the MITRE ATT&CK framework. MITRE ATT&CK is a globally accessible knowledge base of adversary tactics, techniques, and procedures (TTPs) based on real-world observations. It helps security teams better understand and track adversaries by creating a named group, which aligns with the scenario described in the question. The framework is widely recognized and referenced in the cybersecurity industry, including in CompTIA Security+ study materials. References: 1. [CompTIA Security+ Certification Exam Objectives \(SY0-601\)](#):

<https://www.comptia.jp/pdf/Security%2B%20SY0-601%20Exam%20Objectives.pdf> 2. MITRE ATT&CK: <https://attack.mitre.org/>

MITRE ATT&CK is a knowledge base of adversary tactics, techniques, and procedures (TTPs) that are observed in real-world cyberattacks. MITRE ATT&CK provides a common framework and language for describing and analyzing cyber threats and their behaviors. MITRE ATT&CK also allows security researchers to create named groups that track specific adversaries based on their TTPs.

The other options are not correct because:

- A. The Cyber Kill Chain is a model that describes the stages of a cyberattack from reconnaissance to exfiltration. The Cyber Kill Chain does not provide a way to create named groups based on adversary TTPs.
- B. The incident response process is a set of procedures and guidelines that defines how an organization should respond to a security incident. The incident response process does not provide a way to create named groups based on adversary TTPs.
- C. The Diamond Model of Intrusion Analysis is a framework that describes the four core features of any intrusion: adversary, capability, infrastructure, and victim. The Diamond Model of Intrusion Analysis does not provide a way to create named groups based on adversary TTPs.

According to CompTIA Security+ SY0-601 Exam Objectives 1.1 Compare and contrast different types of social engineering techniques:

“MITRE ATT&CK is a knowledge base of adversary tactics, techniques, and procedures (TTPs) that are observed in real-world cyberattacks. MITRE ATT&CK provides a common framework and language for describing and analyzing cyber threats and their behaviors.”

References: <https://www.comptia.org/certifications/security#examdetails> <https://www.comptia.org/content/guides/comptia-security-sy0-601-exam-objectives> <https://attack.mitre.org/>

NEW QUESTION 71

- (Exam Topic 1)

A security engineer is hardening existing solutions to reduce application vulnerabilities. Which of the following solutions should the engineer implement FIRST? (Select TWO)

- A. Auto-update
- B. HTTP headers
- C. Secure cookies
- D. Third-party updates
- E. Full disk encryption
- F. Sandboxing

G. Hardware encryption

Answer: AF

Explanation:

Auto-update can help keep the app up-to-date with the latest security fixes and enhancements, and reduce the risk of exploitation by attackers who target outdated or vulnerable versions of the app.

Sandboxing can help isolate the app from other processes and resources on the system, and limit its access and permissions to only what is necessary.

Sandboxing can help prevent the app from being affected by or affecting other applications or system components, and contain any potential damage in case of a breach.

NEW QUESTION 74

- (Exam Topic 1)

A financial institution would like to store its customer data in a cloud but still allow the data to be accessed and manipulated while encrypted. Doing so would prevent the cloud service provider from being able to decipher the data due to its sensitivity. The financial institution is not concerned about computational overheads and slow speeds. Which of the following cryptographic techniques would BEST meet the requirement?

- A. Asymmetric
- B. Symmetric
- C. Homomorphic
- D. Ephemeral

Answer: B

Explanation:

Symmetric encryption allows data to be encrypted and decrypted using the same key. This is useful when the data needs to be accessed and manipulated while still encrypted. References: CompTIA Security+ Study Guide, Exam SY0-601, Chapter 6

NEW QUESTION 75

- (Exam Topic 1)

A systems administrator is considering different backup solutions for the IT infrastructure. The company is looking for a solution that offers the fastest recovery time while also saving the most amount of storage used to maintain the backups. Which of the following recovery solutions would be the BEST option to meet these requirements?

- A. Snapshot
- B. Differential
- C. Full
- D. Tape

Answer: B

Explanation:

Differential backup is a type of backup that backs up all data that has changed since the last full backup. This backup method offers faster recovery than a full backup, as it only needs to restore the full backup and the differential backup, reducing the amount of data that needs to be restored. It also uses less storage than a full backup as it only stores the changes made from the last full backup.

NEW QUESTION 78

- (Exam Topic 1)

Which of the following function as preventive, detective, and deterrent controls to reduce the risk of physical theft? (Select TWO).

- A. Mantraps
- B. Security guards
- C. Video surveillance
- D. Fences
- E. Bollards
- F. Antivirus

Answer: AB

Explanation:

A - a mantrap can trap those personnel with bad intention(preventive), and kind of same as detecting, since you will know if someone is trapped there(detective), and it can deter those personnel from approaching as well(deterrent) B - security guards can sure do the same thing as above, preventing malicious personnel from entering(preventive+deterrent), and notice those personnel as well(detective)

NEW QUESTION 83

- (Exam Topic 1)

When planning to build a virtual environment, an administrator need to achieve the following,

- Establish policies in Limit who can create new VMs
- Allocate resources according to actual utilization'
- Require justification for requests outside of the standard requirements.
- Create standardized categories based on size and resource requirements Which of the following is the administrator MOST likely trying to do?

- A. Implement IaaS replication
- B. Protect against VM escape
- C. Deploy a PaaS
- D. Avoid VM sprawl

Answer: D

Explanation:

The administrator is most likely trying to avoid VM sprawl, which occurs when too many VMs are created and managed poorly, leading to resource waste and increased security risks. The listed actions can help establish policies, resource allocation, and categorization to prevent unnecessary VM creation and ensure proper management. Reference: CompTIA Security+ Certification Exam Objectives, Exam SY0-601, 3.6 Given a scenario, implement the appropriate virtualization components.

NEW QUESTION 88

- (Exam Topic 1)

Which of the following biometric authentication methods is the MOST accurate?

- A. Gait
- B. Retina
- C. Signature
- D. Voice

Answer: B

Explanation:

Retina authentication is the most accurate biometric authentication method. Retina authentication is based on recognizing the unique pattern of blood vessels and other features in the retina. This makes it virtually impossible to duplicate or bypass, making it the most secure form of biometric authentication currently available.

NEW QUESTION 92

- (Exam Topic 1)

A security analyst is investigating multiple hosts that are communicating to external IP addresses during the hours of 2:00 a.m - 4:00 am. The malware has evaded detection by traditional antivirus software. Which of the following types of malware is MOST likely infecting the hosts?

- A. A RAT
- B. Ransomware
- C. Polymorphic
- D. A worm

Answer: A

Explanation:

Based on the given information, the most likely type of malware infecting the hosts is a RAT (Remote Access Trojan). RATs are often used for stealthy unauthorized access to a victim's computer, and they can evade traditional antivirus software through various sophisticated techniques. In particular, the fact that the malware is communicating with external IP addresses during specific hours suggests that it may be under the control of an attacker who is issuing commands from a remote location. Ransomware, polymorphic malware, and worms are also possible culprits, but the context of the question suggests that a RAT is the most likely answer.

NEW QUESTION 93

- (Exam Topic 1)

Which of the following incident response steps occurs before containment?

- A. Eradication
- B. Recovery
- C. Lessons learned
- D. Identification

Answer: D

Explanation:

Identification is the first step in the incident response process, which involves recognizing that an incident has occurred. Containment is the second step, followed by eradication, recovery, and lessons learned.

References: CompTIA Security+ Study Guide, Exam SY0-601, 4th Edition, Chapter 10: Incident Response and Recovery, pp. 437-441.

NEW QUESTION 94

- (Exam Topic 1)

A security analyst wants to verify that a client-server (non-web) application is sending encrypted traffic. Which of the following should the analyst use?

- A. openssl
- B. hping
- C. netcat
- D. tcpdump

Answer: A

Explanation:

To verify that a client-server (non-web) application is sending encrypted traffic, a security analyst can use OpenSSL. OpenSSL is a software library that provides cryptographic functions, including encryption and decryption, in support of various security protocols, including SSL/TLS. It can be used to check whether a client-server application is using encryption to protect traffic. References:

➤ CompTIA Security+ Certification Exam Objectives - Exam SY0-601

NEW QUESTION 98

- (Exam Topic 1)

A company was compromised, and a security analyst discovered the attacker was able to get access to a service account. The following logs were discovered

during the investigation:

```
User account 'JHDoe' does not exist...
User account 'VMAdmin' does not exist...
User account 'tomcat' wrong password...
User account 'Admin' does not exist...
```

Which of the following MOST likely would have prevented the attacker from learning the service account name?

- A. Race condition testing
- B. Proper error handling
- C. Forward web server logs to a SIEM
- D. Input sanitization

Answer: D

Explanation:

Input sanitization can help prevent attackers from learning the service account name by removing potentially harmful characters from user input, reducing the likelihood of successful injection attacks. References:

- CompTIA Security+ Certification Exam Objectives 2.2: Given a scenario, implement secure coding techniques.
- CompTIA Security+ Study Guide, Sixth Edition, pages 72-73

NEW QUESTION 99

- (Exam Topic 1)

A security analyst reviews a company's authentication logs and notices multiple authentication failures. The authentication failures are from different usernames that share the same source IP address. Which of the password attacks is MOST likely happening?

- A. Dictionary
- B. Rainbow table
- C. Spraying
- D. Brute-force

Answer: C

Explanation:

Detailed

Password spraying is an attack where an attacker tries a small number of commonly used passwords against a large number of usernames. The goal of password spraying is to avoid detection by avoiding too many failed login attempts for any one user account. The fact that different usernames are being attacked from the same IP address is a strong indication that a password spraying attack is underway.

NEW QUESTION 104

- (Exam Topic 1)

A company is implementing a new SIEM to log and send alerts whenever malicious activity is blocked by its antivirus and web content filters. Which of the following is the primary use case for this scenario?

- A. Implementation of preventive controls
- B. Implementation of detective controls
- C. Implementation of deterrent controls
- D. Implementation of corrective controls

Answer: B

Explanation:

A Security Information and Event Management (SIEM) system is a tool that collects and analyzes security-related data from various sources to detect and respond to security incidents. References: CompTIA Security+ Study Guide 601, Chapter 5

NEW QUESTION 106

- (Exam Topic 1)

Which of the following identifies the point in time when an organization will recover data in the event of an outage?

- A. SLA
- B. RPO
- C. MTBF
- D. ARO

Answer: B

Explanation:

Detailed

Recovery Point Objective (RPO) is the maximum duration of time that an organization can tolerate data loss in the event of an outage. It identifies the point in time when data recovery must begin, and any data loss beyond that point is considered unacceptable.

Reference: CompTIA Security+ Certification Guide, Exam SY0-601 by Mike Chapple and David Seidl, Chapter-7: Incident Response and Recovery, Objective 7.2: Compare and contrast business continuity and disaster recovery concepts, pp. 349-350.

NEW QUESTION 109

- (Exam Topic 1)

A grocery store is expressing security and reliability concerns regarding the on-site backup strategy currently being performed by locally attached disks. The main

concerns are the physical security of the backup media and the durability of the data stored on these devices Which of the following is a cost-effective approach to address these concerns?

- A. Enhance resiliency by adding a hardware RAID.
- B. Move data to a tape library and store the tapes off-site
- C. Install a local network-attached storage.
- D. Migrate to a cloud backup solution

Answer: D

Explanation:

a backup strategy is a plan that defines how to protect data from loss or corruption by creating and storing copies of data on a different medium or location¹. A backup strategy should consider the security and reliability of the backup data and the backup storage²³⁴.

Based on these definitions, the best option that is a cost-effective approach to address the security and reliability concerns regarding the on-site backup strategy would be D. Migrate to a cloud backup solutio²ⁿ⁴. A cloud backup solution can provide several benefits, such as:

- Enhanced physical security of the backup data by storing it in a remote location that is protected by multiple layers of security measures.
- Enhanced durability of the backup data by storing it on highly reliable storage devices that are replicated across multiple availability zones or regions.
- Reduced costs of backup storage by paying only for the amount of data stored and transferred, and by using features such as compression, deduplication, encryption, and lifecycle management.
- Increased flexibility and scalability of backup storage by choosing from various storage classes and tiers that match the performance and availability requirements of the backup data.

NEW QUESTION 111

- (Exam Topic 1)

A security architect is implementing a new email architecture for a company. Due to security concerns, the Chief Information Security Officer would like the new architecture to support email encryption, as well as provide for digital signatures. Which of the following should the architect implement?

- A. TOP
- B. IMAP
- C. HTTPS
- D. S/MIME

Answer: D

Explanation:

S/MIME (Secure/Multipurpose Internet Mail Extensions) is a protocol that enables secure email messages to be sent and received. It provides email encryption, as well as digital signatures, which can be used to verify the authenticity of the sender. S/MIME can be used with a variety of email protocols, including POP and IMAP.

References:

- <https://www.comptia.org/content/guides/what-is-smime>
- CompTIA Security+ Study Guide, Sixth Edition (SY0-601), page 139

NEW QUESTION 116

- (Exam Topic 1)

A third party asked a user to share a public key for secure communication. Which of the following file formats should the user choose to share the key?

- A. .pfx
- B. .csr
- C. .pvk
- D. .cer

Answer: D

Explanation:

A user should choose the .cer file format to share a public key for secure communication. A .cer file is a public key certificate that can be shared with third parties to enable secure communication.

References: CompTIA Security+ Study Guide, Exam SY0-601, 4th Edition, Chapter 6: Cryptography, pp. 301-302.

A public key is a cryptographic key that can be used to encrypt or verify data. A public key file is a file that contains one or more public keys in a specific format. There are different formats for public key files, depending on the application and the algorithm used. Some of the common formats are:

- .pfx: This is a file format that stores a certificate and its private and public keys. It is also known as PKCS#12 or Personal Information Exchange. It is used by some applications such as Microsoft Internet Explorer and Outlook to import and export certificates and keys.¹
- .csr: This is a file format that stores a Certificate Signing Request, which is a message sent to a Certificate Authority (CA) to request a digital certificate. It contains the public key and some information about the identity of the requester. It is also known as PKCS#10 or Certification Request Syntax.²
- .pvk: This is a file format that stores a private key for Microsoft Authenticode code signing. It is used with a .spc file that contains the certificate and public key.³
- .cer: This is a file format that stores a certificate, which is a document that binds a public key to an identity. It is also known as DER or Distinguished Encoding Rules. It is used by some applications such as OpenSSL and Java to read and write certificates.⁴

NEW QUESTION 120

- (Exam Topic 1)

The security team received a report of copyright infringement from the IP space of the corporate network. The report provided a precise time stamp for the incident as well as the name of the copyrighted files. The analyst has been tasked with determining the infringing source machine and instructed to implement measures to prevent such incidents from occurring again. Which of the following is MOST capable of accomplishing both tasks?

- A. HIDS
- B. Allow list
- C. TPM
- D. NGFW

Answer: D

Explanation:

Next-Generation Firewalls (NGFWs) are designed to provide advanced threat protection by combining traditional firewall capabilities with intrusion prevention, application control, and other security features. NGFWs can detect and block unauthorized access attempts, malware infections, and other suspicious activity. They can also be used to monitor file access and detect unauthorized copying or distribution of copyrighted material.

A next-generation firewall (NGFW) can be used to detect and prevent copyright infringement by analyzing network traffic and blocking unauthorized transfers of copyrighted material. Additionally, NGFWs can be configured to enforce access control policies that prevent unauthorized access to sensitive resources.

References:

➤ CompTIA Security+ Study Guide, Exam SY0-601, 4th Edition, Chapter 6

NEW QUESTION 124

- (Exam Topic 1)

During a security assessment, a security finds a file with overly permissive permissions. Which of the following tools will allow the analyst to reduce the permission for the existing users and groups and remove the set-user-ID from the file?

- A. 1s
- B. chflags
- C. chmod
- D. lsof
- E. setuid

Answer: C

Explanation:

The chmod command is used to change the permissions of a file or directory. The analyst can use chmod to reduce the permissions for existing users and groups and remove the set-user-ID bit from the file. References:

➤ CompTIA Security+ Study Guide Exam SY0-601, Chapter 6

NEW QUESTION 126

- (Exam Topic 1)

As part of the lessons-learned phase, the SOC is tasked with building methods to detect if a previous incident is happening again. Which of the following would allow the security analyst to alert the SOC if an event is reoccurring?

- A. Creating a playbook within the SOAR
- B. Implementing rules in the NGFW
- C. Updating the DLP hash database
- D. Publishing a new CRL with revoked certificates

Answer: A

Explanation:

Creating a playbook within the Security Orchestration, Automation and Response (SOAR) tool would allow the security analyst to detect if an event is reoccurring by triggering automated actions based on the previous incident's characteristics. This can help the SOC to respond quickly and effectively to the incident.

References: CompTIA Security+ Study Guide, Exam SY0-601, 4th Edition, Chapter 7: Incident Response, pp. 352-354

NEW QUESTION 129

- (Exam Topic 1)

Which of the following would MOST likely be identified by a credentialed scan but would be missed by an uncredentialed scan?

- A. Vulnerabilities with a CVSS score greater than 6.9.
- B. Critical infrastructure vulnerabilities on non-IP protocols.
- C. CVEs related to non-Microsoft systems such as printers and switches.
- D. Missing patches for third-party software on Windows workstations and servers.

Answer: D

Explanation:

An uncredentialed scan would miss missing patches for third-party software on Windows workstations and servers. A credentialed scan, however, can scan the registry and file system to determine the patch level of third-party applications. References: CompTIA Security+ Study Guide by Emmett Dulaney, Chapter 4: Identity and Access Management, The Importance of Credentialing Scans

NEW QUESTION 133

- (Exam Topic 1)

The spread of misinformation surrounding the outbreak of a novel virus on election day led to eligible voters choosing not to take the risk of going the polls. This is an example of:

- A. prepending.
- B. an influence campaign.
- C. a watering-hole attack.
- D. intimidation.
- E. information elicitation.

Answer: B

Explanation:

This scenario describes an influence campaign, where false information is spread to influence or manipulate people's beliefs or actions. In this case, the misinformation led eligible voters to avoid polling places, which influenced the outcome of the election.

NEW QUESTION 134

- (Exam Topic 1)

A global company is experiencing unauthorized logging due to credential theft and account lockouts caused by brute-force attacks. The company is considering implementing a third-party identity provider to help mitigate these attacks. Which of the following would be the BEST control for the company to require from prospective vendors?

- A. IP restrictions
- B. Multifactor authentication
- C. A banned password list
- D. A complex password policy

Answer: B

Explanation:

Multifactor authentication (MFA) would be the best control to require from a third-party identity provider to help mitigate attacks such as credential theft and brute-force attacks. References: CompTIA Security+ Study Guide, Exam SY0-601, Chapter 2

NEW QUESTION 136

- (Exam Topic 1)

An employee received multiple messages on a mobile device. The messages instructing the employee to pair the device to an unknown device. Which of the following BEST describes What a malicious person might be doing to cause this issue to occur?

- A. Jamming
- B. Bluesnarfing
- C. Evil twin
- D. Rogue access point

Answer: B

Explanation:

Bluesnarfing is a hacking technique that exploits Bluetooth connections to snatch data from a wireless device. An attacker can perform bluesnarfing when the Bluetooth function is on and your device is discoverable by other devices within range. In some cases, attackers can even make calls from their victim's phone.

NEW QUESTION 141

- (Exam Topic 1)

A cybersecurity administrator needs to allow mobile BYOD devices to access network resources. As the devices are not enrolled to the domain and do not have policies applied to them, which of the following are best practices for authentication and infrastructure security? (Select TWO).

- A. Create a new network for the mobile devices and block the communication to the internal network and servers
- B. Use a captive portal for user authentication.
- C. Authenticate users using OAuth for more resiliency
- D. Implement SSO and allow communication to the internal network
- E. Use the existing network and allow communication to the internal network and servers.
- F. Use a new and updated RADIUS server to maintain the best solution

Answer: BC

Explanation:

When allowing mobile BYOD devices to access network resources, using a captive portal for user authentication and authenticating users using OAuth are both best practices for authentication and infrastructure security. A captive portal requires users to authenticate before accessing the network and can be used to enforce policies and restrictions. OAuth allows users to authenticate using third-party providers, reducing the risk of password reuse and credential theft.

References: CompTIA Security+ Study Guide, pages 217-218, 225-226

NEW QUESTION 142

- (Exam Topic 1)

The help desk has received calls from users in multiple locations who are unable to access core network services The network team has identified and turned off the network switches using remote commands. Which of the following actions should the network team take NEXT?

- A. Disconnect all external network connections from the firewall
- B. Send response teams to the network switch locations to perform updates
- C. Turn on all the network switches by using the centralized management software
- D. Initiate the organization's incident response plan.

Answer: D

Explanation:

An incident response plan is a set of procedures and guidelines that defines how an organization should respond to a security incident. An incident response plan typically includes the following phases: preparation, identification, containment, eradication, recovery, and lessons learned.

If the help desk has received calls from users in multiple locations who are unable to access core network services, it could indicate that a network outage or a denial-of-service attack has occurred. The network team has identified and turned off the network switches using remote commands, which could be a containment measure to isolate the affected devices and prevent further damage.

The next action that the network team should take is to initiate the organization's incident response plan, which would involve notifying the appropriate stakeholders, such as management, security team, legal team, etc., and following the predefined steps to investigate, analyze, document, and resolve the incident. The other options are not correct because:

- A. Disconnect all external network connections from the firewall. This could be another containment measure to prevent external attackers from accessing the network, but it would also disrupt legitimate network traffic and services. This action should be taken only if it is part of the incident response plan and after notifying the relevant parties.
- B. Send response teams to the network switch locations to perform updates. This could be a recovery measure to restore normal network operations and apply patches or updates to prevent future incidents, but it should be done only after the incident has been properly identified, contained, and eradicated.

➤ C. Turn on all the network switches by using the centralized management software. This could be a recovery measure to restore normal network operations, but it should be done only after the incident has been properly identified, contained, and eradicated.

According to CompTIA Security+ SY0-601 Exam Objectives 1.5 Given a scenario, analyze indicators of compromise and determine the type of malware:

“An incident response plan is a set of procedures and guidelines that defines how an organization should respond to a security incident. An incident response plan typically includes the following phases: preparation, identification, containment, eradication, recovery, and lessons learned.”

References: <https://www.comptia.org/certifications/security#examdetails> <https://www.comptia.org/content/guides/comptia-security-sy0-601-exam-objectives>

NEW QUESTION 147

- (Exam Topic 1)

A dynamic application vulnerability scan identified code injection could be performed using a web form. Which of the following will be BEST remediation to prevent this vulnerability?

- A. Implement input validations
- B. Deploy MFA
- C. Utilize a WAF
- D. Configure HIPS

Answer: A

Explanation:

Implementing input validations will prevent code injection attacks by verifying the type and format of user input. References: CompTIA Security+ Study Guide: Exam SY0-601, Chapter 8

NEW QUESTION 150

- (Exam Topic 1)

A security engineer is reviewing the logs from a SAML application that is configured to use MFA, during this review the engineer notices a high volume of successful logins that did not require MFA from users who were traveling internationally. The application, which can be accessed without a VPB, has a policy that allows time-based tokens to be generated. Users who changed locations should be required to reauthenticate but have been Which of the following statements BEST explains the issue?

- A. OpenID is mandatory to make the MFA requirements work
- B. An incorrect browser has been detected by the SAML application
- C. The access device has a trusted certificate installed that is overwriting the session token
- D. The user's IP address is changing between logins, but the application is not invalidating the token

Answer: D

NEW QUESTION 151

- (Exam Topic 1)

A business is looking for a cloud service provider that offers a la carte services, including cloud backups, VM elasticity, and secure networking. Which of the following cloud service provider types should business engage?

- A. A IaaS
- B. PaaS
- C. XaaS
- D. SaaS

Answer: A

Explanation:

Infrastructure as a Service (IaaS) providers offer a la carte services, including cloud backups, VM elasticity, and secure networking. With IaaS, businesses can rent infrastructure components such as virtual machines, storage, and networking from a cloud service provider. References: CompTIA Security+ Study Guide, pages 233-234

NEW QUESTION 156

- (Exam Topic 1)

A new vulnerability in the SMB protocol on the Windows systems was recently discovered, but no patches are currently available to resolve the issue. The security administrator is concerned if servers in the company's DMZ will be vulnerable to external attack; however, the administrator cannot disable the service on the servers, as SMB is used by a number of internal systems and applications on the LAN. Which of the following TCP ports should be blocked for all external inbound connections to the DMZ as a workaround to protect the servers? (Select TWO).

- A. 135
- B. 139
- C. 143
- D. 161
- E. 443
- F. 445

Answer: BF

Explanation:

To protect the servers in the company's DMZ from external attack due to the new vulnerability in the SMB protocol on the Windows systems, the security administrator should block TCP ports 139 and 445 for all external inbound connections to the DMZ. SMB uses TCP port 139 and 445. Blocking these ports will prevent external attackers from exploiting the vulnerability in SMB protocol on Windows systems. Blocking TCP ports 139 and 445 for all external inbound connections to the DMZ can help protect the servers, as these ports are used by SMB protocol. Port 135 is also associated with SMB, but it is not commonly used. Ports 143 and 161 are associated with other protocols and services. Reference: CompTIA Security+ Certification Exam Objectives, Exam SY0-601, 1.4 Compare and contrast network architecture and technologies.

NEW QUESTION 157

- (Exam Topic 1)

A large enterprise has moved all its data to the cloud behind strong authentication and encryption. A sales director recently had a laptop stolen, and later, enterprise data was found to have been compromised from a local database. Which of the following was the MOST likely cause?

- A. Shadow IT
- B. Credential stuffing
- C. SQL injection
- D. Man in the browser
- E. Bluejacking

Answer: A

Explanation:

The most likely cause of the enterprise data being compromised from a local database is Shadow IT. Shadow IT is the use of unauthorized applications or devices by employees to access company resources. In this case, the sales director's laptop was stolen, and the attacker was able to use it to access the local database, which was not secured properly, allowing unauthorized access to sensitive data. References:

➤ [CompTIA Security+ Certification Exam Objectives - Exam SY0-601](#)

NEW QUESTION 159

- (Exam Topic 1)

A Chief information Officer is concerned about employees using company-issued laptops to steal data when accessing network shares Which of the following should the company implement?

- A. DLP
- B. CASB
- C. HIDS
- D. EDR
- E. UEFI

Answer: A

Explanation:

Detailed

Data Loss Prevention (DLP) can help prevent employees from stealing data by monitoring and controlling access to sensitive data. DLP can also detect and block attempts to transfer sensitive data outside of the organization, such as via email, file transfer, or cloud storage.

References: CompTIA Security+ Study Guide: Exam SY0-601, Chapter 10: Managing Identity and Access, p. 465

NEW QUESTION 164

- (Exam Topic 1)

Which of the following involves the inclusion of code in the main codebase as soon as it is written?

- A. Continuous monitoring
- B. Continuous deployment
- C. Continuous Validation
- D. Continuous integration

Answer: D

Explanation:

Detailed

Continuous Integration (CI) is a practice where developers integrate code into a shared repository frequently, preferably several times a day. Each integration is verified by an automated build and automated tests. CI allows for the detection of errors early in the development cycle, thereby reducing overall development costs.

NEW QUESTION 165

- (Exam Topic 1)

Which of the following must be in place before implementing a BCP?

- A. SLA
- B. AUP
- C. NDA
- D. BIA

Answer: D

Explanation:

A Business Impact Analysis (BIA) is a critical component of a Business Continuity Plan (BCP). It identifies and prioritizes critical business functions and determines the impact of their disruption. References: CompTIA Security+ Study Guide 601, Chapter 10

NEW QUESTION 169

- (Exam Topic 1)

Employees at a company are receiving unsolicited text messages on their corporate cell phones. The unsolicited text messages contain a password reset Link. Which of the attacks is being used to target the company?

- A. Phishing
- B. Vishing
- C. Smishing

D. Spam

Answer: C

Explanation:

Smishing is a type of phishing attack which begins with an attacker sending a text message to an individual. The message contains social engineering tactics to convince the person to click on a malicious link or send sensitive information to the attacker. Criminals use smishing attacks for purposes like:

Learn login credentials to accounts via credential phishing Discover private data like social security numbers

Send money to the attacker Install malware on a phone

Establish trust before using other forms of contact like phone calls or emails

Attackers may pose as trusted sources like a government organization, a person you know, or your bank. And messages often come with manufactured urgency and time-sensitive threats. This can make it more difficult for a victim to notice a scam.

Phone numbers are easy to spoof with VoIP texting, where users can create a virtual number to send and receive texts. If a certain phone number is flagged for spam, criminals can simply recycle it and use a new one.

NEW QUESTION 174

- (Exam Topic 1)

A user attempts to load a web-based application, but the expected login screen does not appear A help desk analyst troubleshoots the issue by running the following command and reviewing the output on the user's PC

```
user> nslookup software-solution.com
Server: rogue.comptia.com
Address: 172.16.1.250
Non-authoritative answer:
Name: software-solution.com
Address: 10.20.10.10
```

The help desk analyst then runs the same command on the local PC

```
helpdesk> nslookup software-solution.com
Server: dns.comptia.com
Address: 172.16.1.1
Non-authoritative answer:
Name: software-solution.com
Address: 172.16.1.10
```

Which of the following BEST describes the attack that is being detected?

- A. Domain hijacking
- B. DNS poisoning
- C. MAC flooding
- D. Evil twin

Answer: B

Explanation:

DNS poisoning, also known as DNS spoofing or DNS cache poisoning, is a form of computer security hacking in which corrupt Domain Name System (DNS) data is introduced into the DNS resolver's cache, causing the name server to return an incorrect result record, such as an IP address. This results in traffic being diverted to the attacker's computer (or any other malicious destination).

DNS poisoning can be performed by various methods, such as:

- > Intercepting and forging DNS responses from legitimate servers
 - > Compromising DNS servers and altering their records
 - > Exploiting vulnerabilities in DNS protocols or implementations
 - > Sending malicious emails or links that trigger DNS queries with poisoned responses
- According to CompTIA Security+ SY0-601 Exam Objectives 1.4 Given a scenario, analyze potential

indicators to determine the type of attack:

"DNS poisoning, also known as DNS spoofing or DNS cache poisoning, is a form of computer security hacking in which corrupt Domain Name System (DNS) data is introduced into the DNS resolver's cache, causing the name server to return an incorrect result record."

References: <https://www.comptia.org/certifications/security#examdetails> <https://www.comptia.org/content/guides/comptia-security-sy0-601-exam-objectives>

<https://www.cloudflare.com/learning/dns/dns-cache-poisoning/>

NEW QUESTION 179

- (Exam Topic 1)

A developer is building a new portal to deliver single-pane-of-glass management capabilities to customers with multiple firewalls. To Improve the user experience, the developer wants to implement an authentication and authorization standard that uses security tokens that contain assertions to pass user Information between nodes. Which of the following roles should the developer configure to meet these requirements? (Select TWO).

- A. Identity processor
- B. Service requestor
- C. Identity provider
- D. Service provider
- E. Tokenized resource
- F. Notarized referral

Answer: CD

Explanation:

An identity provider (IdP) is responsible for authenticating users and generating security tokens containing user information. A service provider (SP) is responsible for accepting security tokens and granting access to resources based on the user's identity.

NEW QUESTION 182

- (Exam Topic 1)

The Chief Information Security Officer (CISO) has decided to reorganize security staff to concentrate on incident response and to outsource outbound Internet URL

categorization and filtering to an outside company. Additionally, the CISO would like this solution to provide the same protections even when a company laptop or mobile device is away from a home office. Which of the following should the CISO choose?

- A. CASB
- B. Next-generation SWG
- C. NGFW
- D. Web-application firewall

Answer: B

Explanation:

The solution that the CISO should choose is Next-generation Secure Web Gateway (SWG), which provides URL filtering and categorization to prevent users from accessing malicious sites, even when they are away from the office. NGFWs are typically cloud-based and offer multiple security layers, including malware detection, intrusion prevention, and data loss prevention. References:

➤ CompTIA Security+ Study Guide Exam SY0-601, Chapter 4

NEW QUESTION 185

- (Exam Topic 1)

A security incident has been resolved Which of the following BEST describes the importance of the final phase of the incident response plan?

- A. It examines and documents how well the team responded discovers what caused the incident, and determines how the incident can be avoided in the future
- B. It returns the affected systems back into production once systems have been fully patched, data restored and vulnerabilities addressed
- C. It identifies the incident and the scope of the breach how it affects the production environment, and the ingress point
- D. It contains the affected systems and disconnects them from the network, preventing further spread of the attack or breach

Answer: A

Explanation:

The final phase of an incident response plan is the post-incident activity, which involves examining and documenting how well the team responded, discovering what caused the incident, and determining how the incident can be avoided in the future. References: CompTIA Security+ Certification Exam Objectives - 2.5 Given a scenario, analyze potential indicators to determine the type of attack. Study Guide: Chapter 5, page 225.

NEW QUESTION 186

- (Exam Topic 1)

The technology department at a large global company is expanding its Wi-Fi network infrastructure at the headquarters building Which of the following should be closely coordinated between the technology, cybersecurity, and physical security departments?

- A. Authentication protocol
- B. Encryption type
- C. WAP placement
- D. VPN configuration

Answer: C

Explanation:

WAP stands for wireless access point, which is a device that allows wireless devices to connect to a wired network using Wi-Fi or Bluetooth. WAP placement refers to where and how WAPs are installed in a building or area.

WAP placement should be closely coordinated between the technology, cybersecurity, and physical security departments because it affects several aspects of network performance and security, such as:

➤ Coverage: WAP placement determines how well wireless devices can access the network throughout the building or area. WAPs should be placed in locations that provide optimal signal strength and avoid interference from other sources.

➤ Capacity: WAP placement determines how many wireless devices can connect to the network simultaneously without affecting network speed or quality. WAPs should be placed in locations that balance network load and avoid congestion or bottlenecks.

➤ Security: WAP placement determines how vulnerable wireless devices are to eavesdropping or hacking attacks from outside or inside sources. WAPs should be placed in locations that minimize exposure to unauthorized access and maximize encryption and authentication methods.

NEW QUESTION 189

- (Exam Topic 1)

A security analyst has received several reports of an issue on an internal web application. Users state they are having to provide their credentials twice to log in. The analyst checks with the application team and notes this is not an expected behavior. After looking at several logs, the analyst decides to run some commands on the gateway and obtains the following output:

Internet address	Physical address	Type
192.168.1.1	ff-ec-ab-00-aa-78	dynamic
192.168.1.5	ff-00-5e-48-00-fb	dynamic
192.168.1.8	00-0c-29-1a-e7-fa	dynamic
192.168.1.10	fc-41-5e-48-00-ff	dynamic
224.215.54.47	fc-00-5e-48-00-fb	static

Which of the following BEST describes the attack the company is experiencing?

- A. MAC flooding
- B. URL redirection
- C. ARP poisoning
- D. DNS hijacking

Answer: C

Explanation:

The output of the “netstat -ano” command shows that there are two connections to the same IP address and port number. This indicates that there are two active

sessions between the client and server.

The issue of users having to provide their credentials twice to log in is known as a double login prompt issue. This issue can occur due to various reasons such as incorrect configuration of authentication settings, incorrect configuration of web server settings, or issues with the client's browser.

Based on the output of the "netstat -ano" command, it is difficult to determine the exact cause of the issue. However, it is possible that an attacker is intercepting traffic between the client and server and stealing user credentials. This type of attack is known as C. ARP poisoning.

ARP poisoning is a type of attack where an attacker sends fake ARP messages to associate their MAC address with the IP address of another device on the network. This allows them to intercept traffic between the two devices and steal sensitive information such as user credentials.

NEW QUESTION 190

- (Exam Topic 1)

During an investigation, the incident response team discovers that multiple administrator accounts were suspected of being compromised. The host audit logs indicate a repeated brute-force attack on a single administrator account followed by suspicious logins from unfamiliar geographic locations. Which of the following data sources would be BEST to use to assess the accounts impacted by this attack?

- A. User behavior analytics
- B. Dump files
- C. Bandwidth monitors
- D. Protocol analyzer output

Answer: A

Explanation:

User behavior analytics (UBA) would be the best data source to assess the accounts impacted by the attack, as it can identify abnormal activity, such as repeated brute-force attacks and logins from unfamiliar geographic locations, and provide insights into the behavior of the impacted accounts. References: CompTIA Security+ Study Guide, Exam SY0-601, 4th Edition, Chapter 7: Incident Response, pp. 338-341

NEW QUESTION 195

- (Exam Topic 1)

one of the attendees starts to notice delays in the connection. and the HTTPS site requests are reverting to HTTP. Which of the following BEST describes what is happening?

- A. Birthday collision on the certificate key
- B. DNS hacking to reroute traffic
- C. Brute force to the access point
- D. A SSL/TLS downgrade

Answer: D

Explanation:

The scenario describes a Man-in-the-Middle (MitM) attack where the attacker intercepts traffic and downgrades the secure SSL/TLS connection to an insecure HTTP connection. This type of attack is commonly known as SSL/TLS downgrade attack or a stripping attack. The attacker is able to see and modify the communication between the client and server.

NEW QUESTION 199

- (Exam Topic 1)

A security engineer needs to create a network segment that can be used for servers that require connections from untrusted networks. Which of the following should the engineer implement?

- A. An air gap
- B. A hot site
- C. A VUAN
- D. A screened subnet

Answer: D

Explanation:

A screened subnet is a network segment that can be used for servers that require connections from untrusted networks. It is placed between two firewalls, with one firewall facing the untrusted network and the other facing the trusted network. This setup provides an additional layer of security by screening the traffic that flows between the two networks. References: CompTIA Security+ Certification Guide, Exam SY0-501

NEW QUESTION 200

- (Exam Topic 1)

The compliance team requires an annual recertification of privileged and non-privileged user access. However, multiple users who left the company six months ago still have access. Which of the following would have prevented this compliance violation?

- A. Account audits
- B. AUP
- C. Password reuse
- D. SSO

Answer: A

Explanation:

Account audits are periodic reviews of user accounts to ensure that they are being used appropriately and that access is being granted and revoked in accordance with the organization's policies and procedures. If the compliance team had been conducting regular account audits, they would have identified the users who left the company six months ago and ensured that their access was revoked in a timely manner. This would have prevented the compliance violation caused by these users still having access to the company's systems.

To prevent this compliance violation, the company should implement account audits. An account audit is a regular review of all user accounts to ensure that they are being used properly and that they are in compliance with the company's security policies. By conducting regular account audits, the company can identify

inactive or unused accounts and remove access for those users. This will help to prevent compliance violations and ensure that only authorized users have access to the company's systems and data.

NEW QUESTION 204

- (Exam Topic 1)

The Chief Technology Officer of a local college would like visitors to utilize the school's WiFi but must be able to associate potential malicious activity to a specific person. Which of the following would BEST allow this objective to be met?

- A. Requiring all new, on-site visitors to configure their devices to use WPS
- B. Implementing a new SSID for every event hosted by the college that has visitors
- C. Creating a unique PSK for every visitor when they arrive at the reception area
- D. Deploying a captive portal to capture visitors' MAC addresses and names

Answer: D

Explanation:

A captive portal is a web page that requires visitors to authenticate or agree to an acceptable use policy before allowing access to the network. By capturing visitors' MAC addresses and names, potential malicious activity can be traced back to a specific person.

NEW QUESTION 209

- (Exam Topic 1)

A network analyst is setting up a wireless access point for a home office in a remote, rural location. The requirement is that users need to connect to the access point securely but do not want to have to remember passwords Which of the following should the network analyst enable to meet the requirement?

- A. MAC address filtering
- B. 802.1X
- C. Captive portal
- D. WPS

Answer: D

Explanation:

The network analyst should enable Wi-Fi Protected Setup (WPS) to allow users to connect to the wireless access point securely without having to remember passwords. WPS allows users to connect to a wireless network by pressing a button or entering a PIN instead of entering a password.

Reference: CompTIA Security+ Study Guide, Exam SY0-601, Chapter 4: Identity and Access Management

NEW QUESTION 214

- (Exam Topic 1)

A security administrator is working on a solution to protect passwords stored in a database against rainbow table attacks Which of the following should the administrator consider?

- A. Hashing
- B. Salting
- C. Lightweight cryptography
- D. Steganography

Answer: B

Explanation:

Salting is a technique that adds random data to a password before hashing it. This makes the hash output more unique and unpredictable, and prevents attackers from using precomputed tables (such as rainbow tables) to crack the password hash. Salting also reduces the risk of collisions, which occur when different passwords produce the same hash.

References: <https://www.comptia.org/certifications/security#examdetails> <https://www.comptia.org/content/guides/comptia-security-sy0-601-exam-objectives>
<https://auth0.com/blog/adding-salt-to-hashing-a-better-way-to-store-passwords/>

NEW QUESTION 219

- (Exam Topic 1)

Remote workers in an organization use company-provided laptops with locally installed applications and locally stored data Users can store data on a remote server using an encrypted connection. The organization discovered data stored on a laptop had been made available to the public Which of the following security solutions would mitigate the risk of future data disclosures?

- A. FDE
- B. TPM
- C. HIDS
- D. VPN

Answer: A

Explanation:

Based on these definitions, the best security solution to mitigate the risk of future data disclosures from a laptop would be FDE123. FDE would prevent unauthorized access to the data stored on the laptop even if it is stolen or lost. FDE can also use TPM to store the encryption key and ensure that only trusted software can decrypt the data3. HIDS and VPN are not directly related to data encryption, but they can provide additional security benefits by detecting intrusions and protecting network traffic respectively.

NEW QUESTION 223

- (Exam Topic 1)

As part of a company's ongoing SOC maturation process, the company wants to implement a method to share cyberthreat intelligence data with outside security partners. Which of the following will the company MOST likely implement?

- A. TAXII
- B. TLP
- C. TTP
- D. STIX

Answer: A

Explanation:

Trusted Automated Exchange of Intelligence Information (TAXII) is a standard protocol that enables the sharing of cyber threat intelligence between organizations. It allows organizations to automate the exchange of information in a secure and timely manner. References: CompTIA Security+ Certification Exam Objectives 3.6 Given a scenario, implement secure network architecture concepts. Study Guide: Chapter 4, page 167.

NEW QUESTION 225

- (Exam Topic 1)

An attacker replaces a digitally signed document with another version that goes unnoticed Upon reviewing the document's contents the author notices some additional verbiage that was not originally in the document but cannot validate an integrity issue. Which of the following attacks was used?

- A. Cryptomalware
- B. Hash substitution
- C. Collision
- D. Phishing

Answer: B

Explanation:

This type of attack occurs when an attacker replaces a digitally signed document with another version that has a different hash value. The author would be able to notice the additional verbiage, however, since the hash value would have changed, they would not be able to validate an integrity issue.

NEW QUESTION 228

- (Exam Topic 1)

The Chief Information Security Officer directed a risk reduction in shadow IT and created a policy requiring all unsanctioned high-risk SaaS applications to be blocked from user access Which of the following is the BEST security solution to reduce this risk?

- A. CASB
- B. VPN concentrator
- C. MFA
- D. VPC endpoint

Answer: A

Explanation:

A Cloud Access Security Broker (CASB) can be used to monitor and control access to cloud-based applications, including unsanctioned SaaS applications. It can help enforce policies that prevent access to high-risk SaaS applications and provide visibility into the use of such applications by employees. References: CompTIA Security+ SY0-601 Exam Objectives: 3.3 Given a scenario, implement secure mobile solutions.

NEW QUESTION 231

- (Exam Topic 2)

Multiple beaconing activities to a malicious domain have been observed. The malicious domain is hosting malware from various endpoints on the network. Which of the following technologies would be best to correlate the activities between the different endpoints?

- A. Firewall
- B. SIEM
- C. IPS
- D. Protocol analyzer

Answer: B

Explanation:

SIEM stands for Security Information and Event Management, which is a technology that collects, analyzes, and correlates data from multiple sources, such as firewall logs, IDS/IPS alerts, network devices, applications, and endpoints. SIEM provides real-time monitoring and alerting of security events, as well as historical analysis and reporting for compliance and forensic purposes.

A SIEM technology would be best to correlate the activities between the different endpoints that are beaconing to a malicious domain. A SIEM can detect the malicious domain by comparing it with threat intelligence feeds or known indicators of compromise (IOCs). A SIEM can also identify the endpoints that are communicating with the malicious domain by analyzing the firewall logs and other network traffic data. A SIEM can alert the security team of the potential compromise and provide them with relevant information for investigation and remediation.

NEW QUESTION 236

- (Exam Topic 2)

A company recently upgraded its authentication infrastructure and now has more computing power. Which of the following should the company consider using to ensure user credentials are being transmitted and stored more securely?

- A. Blockchain
- B. Salting
- C. Quantum
- D. Digital signature

Answer: B

Explanation:

Salting is a technique that adds random data to user credentials before hashing them. This makes the hashed credentials more secure and resistant to brute-force attacks or rainbow table attacks. Salting also ensures that two users with the same password will have different hashed credentials.

A company that has more computing power can consider using salting to ensure user credentials are being transmitted and stored more securely. Salting can increase the complexity and entropy of the hashed credentials, making them harder to crack or reverse.

NEW QUESTION 239

- (Exam Topic 2)

The application development teams have been asked to answer the following questions:

- Does this application receive patches from an external source?
- Does this application contain open-source code?
- Is this application accessible by external users?
- Does this application meet the corporate password standard? Which of the following are these questions part of?

- A. Risk control self-assessment
- B. Risk management strategy
- C. Risk acceptance
- D. Risk matrix

Answer: A

Explanation:

A risk control self-assessment (RCSA) is a process that allows an organization to identify, evaluate, and mitigate the risks associated with its activities, processes, systems, and products. A RCSA involves asking relevant questions to assess the effectiveness of existing controls and identify any gaps or weaknesses that need improvement. A RCSA also helps to align the risk appetite and tolerance of the organization with its strategic objectives and performance.

The application development teams have been asked to answer questions related to their applications' security posture, such as whether they receive patches from an external source, contain open-source code, are accessible by external users, or meet the corporate password standard. These questions are part of a RCSA process that aims to evaluate the potential risks and vulnerabilities associated with each application and determine how well they are managed and mitigated.

NEW QUESTION 242

- (Exam Topic 2)

Sales team members have been receiving threatening voicemail messages and have reported these incidents to the IT security team. Which of the following would be MOST appropriate for the IT security team to analyze?

- A. Access control
- B. Syslog
- C. Session Initiation Protocol traffic logs
- D. Application logs

Answer: B

Explanation:

Syslogs are log files that are generated by devices on the network and contain information about network activity, including user logins, device connections, and other events. By analyzing these logs, the IT security team can identify the source of the threatening voicemail messages and take the necessary steps to address the issue.

NEW QUESTION 247

- (Exam Topic 2)

A security administrator performs weekly vulnerability scans on all cloud assets and provides a detailed report. Which of the following describes the administrator's activities?

- A. Continuous deployment
- B. Continuous integration
- C. Continuous validation
- D. Continuous monitoring

Answer: C

Explanation:

Continuous validation is a process that involves performing regular and automated tests to verify the security and functionality of a system or an application. Continuous validation can help identify and remediate vulnerabilities, bugs, or misconfigurations before they cause any damage or disruption. The security administrator's activities of performing weekly vulnerability scans on all cloud assets and providing a detailed report are examples of continuous validation.

NEW QUESTION 248

- (Exam Topic 2)

A junior human resources administrator was gathering data about employees to submit to a new company awards program. The employee data included job title, business phone number, location, first initial with last name, and race. Which of the following best describes this type of information?

- A. Sensitive
- B. Non-PII
- C. Private
- D. Confidential

Answer: B

Explanation:

Non-PII stands for non-personally identifiable information, which is any data that does not directly identify a specific individual. Non-PII can include information

such as job title, business phone number, location, first initial with last name, and race. Non-PII can be used for various purposes, such as statistical analysis, marketing, or research. However, non-PII may still pose some privacy risks if it is combined or linked with other data that can reveal an individual's identity.
References: <https://www.comptia.org/certifications/security#examdetails> <https://www.comptia.org/content/guides/comptia-security-sy0-601-exam-objectives> <https://www.investopedia.com/terms/n/non-personally-identifiable-information-npii.asp>

NEW QUESTION 250

- (Exam Topic 2)

An attack has occurred against a company.

INSTRUCTIONS

You have been tasked to do the following:

Identify the type of attack that is occurring on the network by clicking on the attacker's tablet and reviewing the output. (Answer Area 1).

Identify which compensating controls should be implemented on the assets, in order to reduce the effectiveness of future attacks by dragging them to the correct server.

(Answer area 2) All objects will be used, but not all placeholders may be filled. Objects may only be used once.

If at any time you would like to bring back the initial state of the simulation, please click the Reset All button.

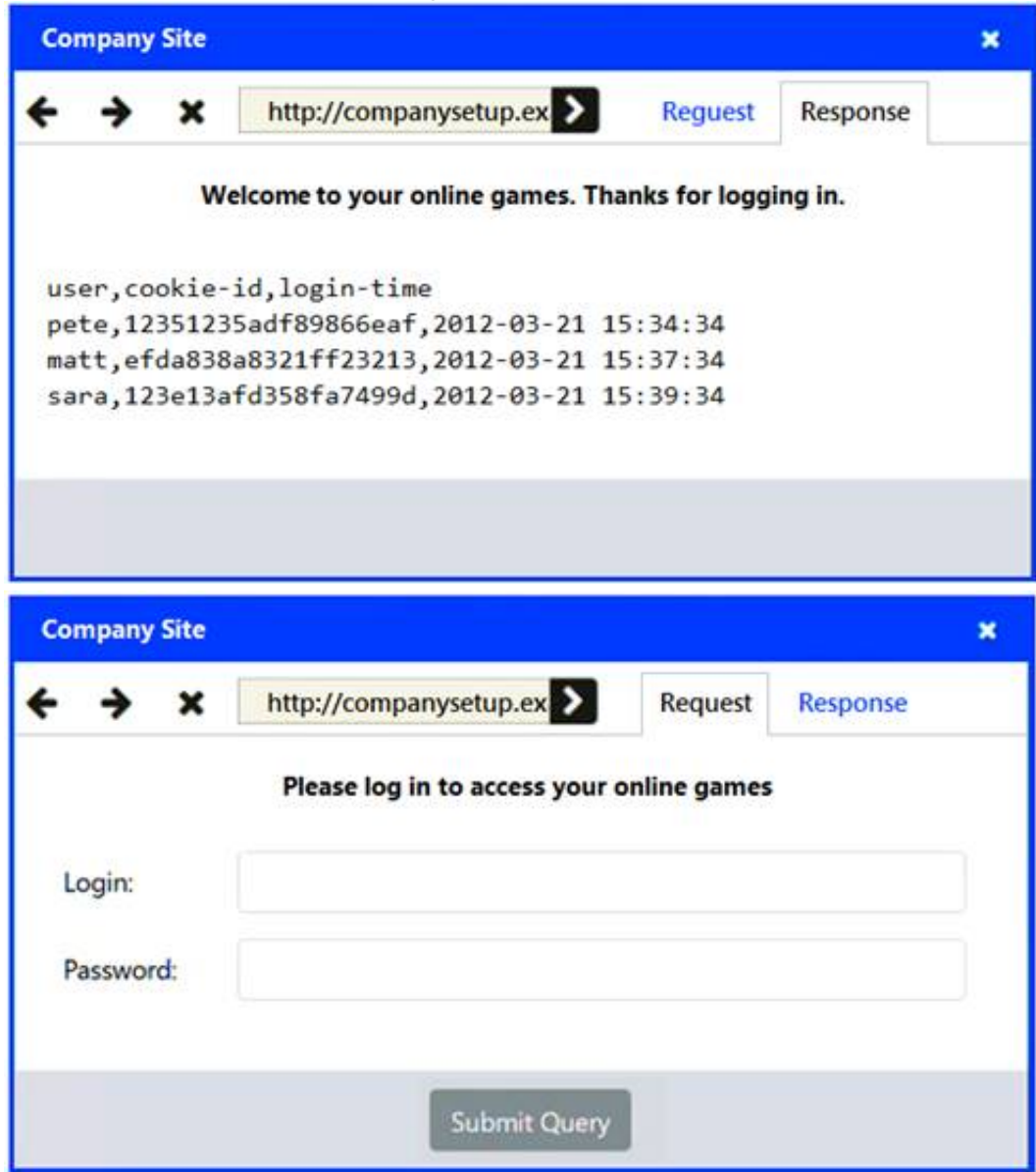

Select and Place:

Answer Area 1

SQL Injection

Cross Site Scripting

XML Injection

Session Hijacking

Type of attack

?

Answer Area 2

Input Validation

Code Review

WAF

URL Filtering

Record level access control

- A. Mastered
- B. Not Mastered

Answer: A

Explanation:

A computer screen shot of a computer Description automatically generated with low confidence

NEW QUESTION 253

- (Exam Topic 2)

A company wants to deploy decoy systems alongside production systems in order to entice threat actors and to learn more about attackers. Which of the following best describes these systems?

- A. DNS sinkholes
- B. Honey pots
- C. Virtual machines
- D. Neural networks

Answer: B

Explanation:

Honey pots are decoy systems or resources that are designed to attract and deceive threat actors and to learn more about their motives, techniques, etc. They can be deployed alongside production systems to create an illusion of a vulnerable target and divert attacks away from the real systems. They can also collect valuable information and evidence about the attackers and their activities for further analysis or prosecution.

NEW QUESTION 254

- (Exam Topic 2)

Which of the following describes software on network hardware that needs to be updated on a routine basis to help address possible vulnerabilities?

- A. Vendor management
- B. Application programming interface
- C. Vanishing
- D. Encryption strength
- E. Firmware

Answer: E

Explanation:

Firmware is software that allows your computer to communicate with hardware devices, such as network routers, switches, or firewalls. Firmware updates can fix bugs, improve performance, and enhance security features. Without firmware updates, the devices you connect to your network might not work properly or might be vulnerable to attacks¹. You can have Windows automatically download recommended drivers and firmware updates for your hardware devices¹, or you can use a network monitoring software to keep track of the firmware status of your devices². You should also follow the best practices for keeping devices and software up to date, such as enforcing automatic updates, monitoring update status, and testing updates before deploying them

NEW QUESTION 257

- (Exam Topic 2)

A cybersecurity analyst at Company A is working to establish a secure communication channel with a counterpart at Company B, which is 3,000 miles (4,828 kilometers) away. Which of the following concepts would help the analyst meet this goal in a secure manner?

- A. Digital signatures
- B. Key exchange
- C. Salting
- D. PPTP

Answer: B

Explanation:

Key exchange Short

Key exchange is the process of securely sharing cryptographic keys between two parties over a public network. This allows them to establish a secure communication channel and encrypt their messages. There are different methods of key exchange, such as Diffie-Hellman or RSA. References:

<https://www.comptia.org/content/guides/what-is-encryption>

NEW QUESTION 261

- (Exam Topic 2)

Which of the following would be best to ensure data is saved to a location on a server, is easily scaled, and is centrally monitored?

- A. Edge computing
- B. Microservices
- C. Containers
- D. Thin client

Answer: C

Explanation:

Containers are a method of virtualization that allow you to run multiple isolated applications on a single server. Containers are lightweight, portable, and scalable, which means they can save resources, improve performance, and simplify deployment. Containers also enable centralized monitoring and management of the applications running on them, using tools such as Docker or Kubernetes. Containers are different from edge computing, which is a distributed computing paradigm that brings computation and data storage closer to the location where it is needed. Microservices are a software architecture style that breaks down complex applications into smaller, independent services that communicate with each other. Thin clients are devices that rely on a server to perform most of the processing tasks and only provide a user interface.

NEW QUESTION 263

- (Exam Topic 2)

An organization recently released a software assurance policy that requires developers to run code scans each night on the repository. After the first night, the security team alerted the developers that more than 2,000 findings were reported and need to be addressed. Which of the following is the MOST likely cause for the high number of findings?

- A. The vulnerability scanner was not properly configured and generated a high number of false positives
- B. Third-party libraries have been loaded into the repository and should be removed from the codebase.
- C. The vulnerability scanner found several memory leaks during runtime, causing duplicate reports for the same issue.
- D. The vulnerability scanner was not loaded with the correct benchmarks and needs to be updated.

Answer: A

Explanation:

The most likely cause for the high number of findings is that the vulnerability scanner was not properly configured and generated a high number of false positives. False positive results occur when a vulnerability scanner incorrectly identifies a non-vulnerable system or application as being vulnerable. This can happen due to incorrect configuration, over-sensitive rule sets, or outdated scan databases.

<https://www.professormesser.com/security-plus/sy0-601/sy0-601-video/sy0-601-comptia-security-plus-course/>

NEW QUESTION 264

- (Exam Topic 2)

A manager for the development team is concerned about reports showing a common set of vulnerabilities. The set of vulnerabilities is present on almost all of the applications developed by the team. Which of the following approaches would be most effective for the manager to use to address this issue?

- A. Tune the accuracy of fuzz testing.
- B. Invest in secure coding training and application security guidelines.
- C. Increase the frequency of dynamic code scans to detect issues faster.
- D. Implement code signing to make code immutable.

Answer: B

Explanation:

Invest in secure coding training and application security guidelines is the most effective approach for the manager to use to address the issue of common vulnerabilities in the applications developed by the team. Secure coding training can help the developers learn how to write code that follows security best practices and avoids common mistakes or flaws that can introduce vulnerabilities. Application security guidelines can provide a set of standards and rules for developing secure applications that meet the company's security requirements and policies. By investing in secure coding training and application security guidelines, the manager can improve the security awareness and skills of the development team and reduce the number of vulnerabilities in their applications. References: 1

CompTIA Security+ Certification Exam Objectives, page 9,

Domain 2.0: Architecture and Design, Objective 2.3: Summarize secure application development, deployment, and automation concepts 2

CompTIA Security+ Certification Exam Objectives, page 10, Domain 2.0:

Architecture and Design, Objective 2.4: Explain the importance of embedded and specialized systems security 3 <https://www.comptia.org/blog/what-is-secure-coding>

NEW QUESTION 268

- (Exam Topic 2)

An organization wants to quickly assess how effectively the IT team hardened new laptops. Which of the following would be the best solution to perform this assessment?

- A. Install a SIEM tool and properly configure it to read the OS configuration files.
- B. Load current baselines into the existing vulnerability scanner.
- C. Maintain a risk register with each security control marked as compliant or non-compliant.
- D. Manually review the secure configuration guide checklists.

Answer: B

Explanation:

A vulnerability scanner is a tool that can scan devices and systems for known vulnerabilities, misconfigurations, and compliance issues. By loading the current baselines into the scanner, the organization can compare the actual state of the new laptops with the desired state and identify any deviations or weaknesses. This is a quick and automated way to assess the hardening of the new laptops.

NEW QUESTION 269

- (Exam Topic 2)

Recent changes to a company's BYOD policy require all personal mobile devices to use a two-factor authentication method that is not something you know or have. Which of the following will meet this requirement?

- A. Facial recognition
- B. Six-digit PIN
- C. PKI certificate
- D. Smart card

Answer: A

Explanation:

Facial recognition is a type of biometric authentication that uses the unique features of a person's face to verify their identity. Facial recognition is not something you know or have, but something you are, which is one of the three factors of authentication. Facial recognition can use various methods and technologies, such as 2D or 3D images, infrared sensors, machine learning and more, to capture, analyze and compare facial data. Facial recognition can provide a convenient and secure way to authenticate users on personal mobile devices, as it does not require any additional hardware or input from the user. Facial recognition can also be used in conjunction with other factors, such as passwords or tokens, to provide multi-factor authentication. Verified References:



Biometrics - SY0-601 CompTIA Security+ : 2.4 - Professor Messer IT Certification Training Courses <https://www.professormesser.com/security-plus/sy0-601/sy0-601-video/biometrics/> (See Facial Recognition)

➤ Security+ (Plus) Certification | CompTIA IT Certifications <https://www.comptia.org/certifications/security> (See Domain 2: Architecture and Design, Objective 2.4: Given a scenario, implement identity and access management controls.)

➤ Biometric and Facial Recognition - CompTIA Security+ Certification (SY0-501) https://www.oreilly.com/library/view/comptia-security-certification/9781789953091/video9_6.html (See Biometric and Facial Recognition)

NEW QUESTION 273

- (Exam Topic 2)

A security administrator needs to provide secure access to internal networks for external partners. The administrator has given the PSK and other parameters to the third-party security administrator. Which of the following is being used to establish this connection?

- A. Kerberos
- B. SSL/TLS
- C. IPSec
- D. SSH

Answer: C

Explanation:

IPSec is a protocol suite that provides secure communication over IP networks. It uses encryption, authentication, and integrity mechanisms to protect data from unauthorized access or modification. IPSec can operate in two modes: transport mode and tunnel mode. In tunnel mode, IPSec can create a virtual private network (VPN) between two endpoints, such as external partners and internal networks. To establish a VPN connection, IPSec requires a pre-shared key (PSK) or other parameters to negotiate the security association. References: <https://www.comptia.org/content/guides/what-is-vpn>

NEW QUESTION 277

- (Exam Topic 2)

A systems administrator needs to install a new wireless network for authenticated guest access. The wireless network should support 802.1X using the most secure encryption and protocol available.

Perform the following steps:

- * 1. Configure the RADIUS server.
- * 2. Configure the WiFi controller.
- * 3. Preconfigure the client for an incoming guest. The guest AD credentials are:

User: guest01 Password: guestpass

- A. Mastered
- B. Not Mastered

Answer: A

Explanation:

Wifi Controller SSID: CORPGUEST

SHARED KEY: Secret

AAA server IP: 192.168.1.20

PSK: Blank

Authentication type: WPA2-EAP-PEAP-MSCHAPv2 Controller IP: 192.168.1.10

Radius Server Shared Key: Secret

Client IP: 192.168.1.10

Authentication Type: Active Directory Server IP: 192.168.1.20

Wireless Client SSID: CORPGUEST

Username: guest01 Userpassword: guestpass PSK: Blank

Authentication type: WPA2-Enterprise

NEW QUESTION 281

- (Exam Topic 2)

Which of the following would be most effective to contain a rapidly spreading attack that is affecting a large number of organizations?

- A. Machine learning
- B. DNS sinkhole
- C. Blocklist

D. Honey pot

Answer: B

Explanation:

A DNS sinkhole would be most effective to contain a rapidly spreading attack that is affecting a large number of organizations. A DNS sinkhole is a technique that involves redirecting malicious or unwanted domain names to an alternative IP address, such as a black hole, a honeypot, or a warning page. A DNS sinkhole can help to prevent or disrupt the communication between infected systems and command-and-control servers, malware distribution sites, phishing sites, or botnets. A DNS sinkhole can also help to identify and isolate infected systems by monitoring the traffic to the sinkhole IP address. References:

<https://www.comptia.org/blog/what-is-a-dns-sinkhole>

<https://www.certblaster.com/wp-content/uploads/2020/11/CompTIA-Security-SY0-601-Exam-Objectives-1.0.pdf>

NEW QUESTION 284

- (Exam Topic 2)

A digital forensics team at a large company is investigating a case in which malicious code was downloaded over an HTTPS connection and was running in memory, but was never committed to disk. Which of the following techniques should the team use to obtain a sample of the malware binary?

- A. pcap reassembly
- B. SSD snapshot
- C. Image volatile memory
- D. Extract from checksums

Answer: C

Explanation:

The best technique for the digital forensics team to use to obtain a sample of the malware binary is to image volatile memory. Volatile memory imaging is a process of collecting a snapshot of the contents of a computer's RAM, which can include active malware programs. According to the CompTIA Security+ SY0-601 Official Text Book, volatile memory imaging can be used to capture active malware programs that are running in memory, but have not yet been committed to disk. This technique is especially useful in cases where the malware is designed to self-destruct or erase itself from the disk after execution.

NEW QUESTION 287

- (Exam Topic 2)

An annual information security has revealed that several OS-level configurations are not in compliance due to Outdated hardening standards the company is using Which Of the following would be best to use to update and reconfigure the OS.level security configurations?

- A. CIS benchmarks
- B. GDPR guidance
- C. Regional regulations
- D. ISO 27001 standards

Answer: A

Explanation:

CIS benchmarks are best practices and standards for securing various operating systems, applications, cloud environments, etc. They are developed by a community of experts and updated regularly to reflect the latest threats and vulnerabilities. They can be used to update and reconfigure the OS-level security configurations to ensure compliance and reduce risks

NEW QUESTION 288

- (Exam Topic 2)

A security team discovered a large number of company-issued devices with non-work-related software installed. Which of the following policies would most likely contain language that would prohibit this activity?

- A. NDA
- B. BPA
- C. AUP
- D. SLA

Answer: C

Explanation:

AUP stands for acceptable use policy, which is a document that defines the rules and guidelines for using an organization's network, systems, devices, and resources. An AUP typically covers topics such as authorized and unauthorized activities, security requirements, data protection, user responsibilities, and consequences for violations. An AUP can help prevent non-work-related software installation on company-issued devices by clearly stating what types of software are allowed or prohibited, and what actions will be taken if users do not comply with the policy.

References: <https://www.comptia.org/certifications/security#examdetails> <https://www.comptia.org/content/guides/comptia-security-sy0-601-exam-objectives>

<https://www.techopedia.com/definition/2471/acceptable-use-policy-aup>

NEW QUESTION 293

- (Exam Topic 2)

A web server has been compromised due to a ransomware attack. Further Investigation reveals the ransomware has been in the server for the past 72 hours. The systems administrator needs to get the services back up as soon as possible. Which of the following should the administrator use to restore services to a secure state?

- A. The last incremental backup that was conducted 72 hours ago
- B. The last known-good configuration stored by the operating system
- C. The last full backup that was conducted seven days ago
- D. The baseline OS configuration

Answer: A

Explanation:

The last incremental backup that was conducted 72 hours ago would be the best option to restore the services to a secure state, as it would contain the most recent data before the ransomware infection. Incremental backups only store the changes made since the last backup, so they are faster and use less storage space than full backups. Restoring from an incremental backup would also minimize the data loss and downtime caused by the ransomware attack. References:

- <https://www.comptia.org/blog/mature-cybersecurity-response-to-ransomware>
- <https://www.youtube.com/watch?v=HszU4nEAlFc>

NEW QUESTION 297

- (Exam Topic 2)

A security engineer is investigating a penetration test report that states the company website is vulnerable to a web application attack. While checking the web logs from the time of the test, the engineer notices several invalid web form submissions using an unusual address: "SELECT * FROM customername". Which of the following is most likely being attempted?

- A. Directory traversal
- B. SQL injection
- C. Privilege escalation
- D. Cross-site scripting

Answer: B

Explanation:

SQL injection is a web application attack that involves inserting malicious SQL statements into an input field, such as a web form, to manipulate or access the database behind the application. SQL injection can be used to perform various actions, such as reading, modifying, or deleting data, executing commands on the database server, or bypassing authentication. In this scenario, the attacker is trying to use a SQL statement "SELECT * FROM customername" to retrieve all data from the customername table in the database.

NEW QUESTION 301

- (Exam Topic 2)

During the onboarding process, an employee needs to create a password for an intranet account. The password must include ten characters, numbers, and letters, and two special characters. Once the password is created, the company will grant the employee access to other company-owned websites based on the intranet profile. Which of the following access management concepts is the company most likely using to safeguard intranet accounts and grant access to multiple sites based on a user's intranet account? (Select two).

- A. Federation
- B. Identity proofing
- C. Password complexity
- D. Default password changes
- E. Password manager
- F. Open authentication

Answer: AF

Explanation:

Federation is an access management concept that allows users to authenticate once and access multiple applications or services that trust the same identity provider. Open authentication is a standard protocol that enables federation by allowing users to use their existing credentials from one service to access another service. The company is most likely using federation and open authentication to safeguard intranet accounts and grant access to multiple sites based on a user's intranet account. For example, the company could use an identity provider such as Azure AD or Keycloak to manage the user identities and credentials for the intranet account, and then use open authentication to allow the users to access other company-owned websites without having to log in again. References:

- <https://www.keycloak.org/>
- <https://learn.microsoft.com/en-us/azure/active-directory/hybrid/connect/whatis-fed>

NEW QUESTION 304

- (Exam Topic 2)

An organization's corporate offices were destroyed due to a natural disaster, so the organization is now setting up offices in a temporary work space. Which of the following will the organization most likely consult?

- A. The business continuity plan
- B. The risk management plan
- C. The communication plan
- D. The incident response plan

Answer: A

Explanation:

A business continuity plan is a document or a process that outlines how an organization can continue its critical operations and functions in the event of a disruption or disaster. It can include strategies and procedures for recovering or relocating resources, personnel, data, etc., to ensure minimal downtime and impact. The organization will most likely consult the business continuity plan when setting up offices in a temporary work space after its corporate offices were destroyed due to a natural disaster.

NEW QUESTION 305

- (Exam Topic 2)

Which of the following is required in order (or an IDS and a WAF to be effective on HTTPS traffic?

- A. Hashing
- B. DNS sinkhole
- C. TLS inspection
- D. Data masking

Answer: C

Explanation:

TLS (Transport Layer Security) is a protocol that is used to encrypt data sent over HTTPS (Hypertext Transfer Protocol Secure). In order for an intrusion detection system (IDS) and a web application firewall (WAF) to be effective on HTTPS traffic, they must be able to inspect the encrypted traffic. TLS inspection allows the IDS and WAF to decrypt and inspect the traffic, allowing them to detect any malicious activity. References: [1] CompTIA Security+ Study Guide Exam SY0-601 [1], Sixth Edition, Chapter 11, "Network Security Monitoring" [2] CompTIA Security+ Get Certified Get Ahead: SY0-501 Study Guide, Chapter 7, "Intrusion Detection and Prevention"

NEW QUESTION 308

- (Exam Topic 2)

Which Of the following vulnerabilities is exploited an attacker Overwrite a reg-ister with a malicious address that changes the execution path?

- A. VM escape
- B. SQL injection
- C. Buffer overflow
- D. Race condition

Answer: C

Explanation:

A buffer overflow is a type of vulnerability that occurs when an attacker sends more data than a buffer can hold, causing the excess data to overwrite adjacent memory locations such as registers. It can allow an attacker to overwrite a register with a malicious address that changes the execution path and executes arbitrary code on the target system

NEW QUESTION 313

- (Exam Topic 2)

An analyst is working on an investigation with multiple alerts for multiple hosts. The hosts are showing signs of being compromised by a fast-spreading worm. Which of the following should be the next step in order to stop the spread?

- A. Disconnect every host from the network.
- B. Run an AV scan on the entire
- C. Scan the hosts that show signs of
- D. Place all known-infected hosts on an isolated network

Answer: D

Explanation:

Placing all known-infected hosts on an isolated network is the best way to stop the spread of a worm infection. This will prevent the worm from reaching other hosts on the network and allow the infected hosts to be cleaned and restored. Disconnecting every host from the network is not practical and may disrupt business operations. Running an AV scan on the entire network or scanning the hosts that show signs of infection may not be effective or fast enough to stop a fast-spreading worm.

NEW QUESTION 314

- (Exam Topic 2)

Which Of the following best ensures minimal downtime for organizations vÃh crit-ical computing equipment located in earthquake-prone areas?

- A. Generators and UPS
- B. Off-site replication
- C. Additional warm site
- D. Local

Answer: B

Explanation:

Off-site replication is a process of copying and storing data in a remote location that is geographically separate from the primary site. It can ensure minimal downtime for organizations with critical computing equipment located in earthquake-prone areas by providing a backup copy of data that can be accessed and restored in case of a disaster or disruption at the primary site.

NEW QUESTION 317

- (Exam Topic 2)

The Chief Executive Officer (CEO) of an organization would like staff members to have the flexibility to work from home anytime during business hours, including during a pandemic or crisis. However, the CEO is concerned that some staff members may take advantage of the flexibility and work from high-risk countries while on holiday or outsource work to a third-party organization in another country. The Chief Information Officer believes the company can implement some basic controls to mitigate the majority of the risk. Which of the following would be best to mitigate the CEO's concerns? (Select two).

- A. Geolocation
- B. Time-of-day restrictions
- C. Certificates
- D. Tokens
- E. Geotagging
- F. Role-based access controls

Answer: AB

Explanation:

Geolocation and time-of-day restrictions would be best to mitigate the CEO's concerns about staff members working from high-risk countries while on holiday or outsourcing work to a third-party organization in another country. Geolocation is a technique that involves determining the physical location of a device or user

based on its IP address, GPS coordinates, Wi-Fi signals, or other indicators. Time-of-day restrictions are policies that limit the access or usage of resources based on the time of day or week. Geolocation and time-of-day restrictions can help to enforce access control rules, prevent unauthorized access, detect anomalous behavior, and comply with regulations. References: <https://www.comptia.org/blog/what-is-geolocation>
<https://www.certblaster.com/wp-content/uploads/2020/11/CompTIA-Security-SY0-601-Exam-Objectives-1.0.pdf>

NEW QUESTION 319

- (Exam Topic 2)

A company purchased cyber insurance to address items listed on the risk register. Which of the following strategies does this represent?

- A. Accept
- B. Transfer
- C. Mitigate
- D. Avoid

Answer: B

Explanation:

A company purchased cyber insurance to address items listed on the risk register. This represents a transfer strategy. A transfer strategy involves transferring or sharing some or all of the responsibility or impact of a risk to another party, such as an insurer, a supplier, or a partner. A transfer strategy can help to reduce the financial liability or exposure of the company in case of a security incident or breach. References: <https://www.comptia.org/blog/what-is-cyber-insurance>
<https://www.certblaster.com/wp-content/uploads/2020/11/CompTIA-Security-SY0-601-Exam-Objectives-1.0.pdf>

NEW QUESTION 323

- (Exam Topic 2)

A security analyst is creating baselines for the server team to follow when hardening new devices for deployment. Which of the following best describes what the analyst is creating?

- A. Change management procedure
- B. Information security policy
- C. Cybersecurity framework
- D. Secure configuration guide

Answer: D

Explanation:

A secure configuration guide is a document that provides an overview of the security features and best practices for a specific product, system, or application. A secure configuration guide helps to reduce unnecessary cyber vulnerabilities and enhance overall security by applying consistent and standardized settings and policies. A security analyst can create baselines for the server team to follow when hardening new devices for deployment based on a secure configuration guide.

* A. Change management procedure. This is not the correct answer, because a change management procedure is a document that describes the steps and processes for implementing, reviewing, and approving changes to an IT system or environment. A change management procedure helps to minimize the risks and impacts of changes on the system performance, availability, and security.

* B. Information security policy. This is not the correct answer, because an information security policy is a document that defines the rules and principles for protecting the confidentiality, integrity, and availability of information assets within an organization. An information security policy helps to establish the roles and responsibilities of employees, managers, and stakeholders regarding information security.

* C. Cybersecurity framework. This is not the correct answer, because a cybersecurity framework is a document that provides a set of standards, guidelines, and best practices for managing cybersecurity risks and improving resilience. A cybersecurity framework helps to align the business objectives and priorities with the security requirements and capabilities.

* D. Secure configuration guide. This is the correct answer, because a secure configuration guide is a document that provides an overview of the security features and best practices for a specific product, system, or application. A secure configuration guide helps to reduce unnecessary cyber vulnerabilities and enhance overall security by applying consistent and standardized settings and policies.

Reference: Secure Configuration Guide, Security Technical Implementation Guide - Wikipedia.

NEW QUESTION 328

.....

Thank You for Trying Our Product

* 100% Pass or Money Back

All our products come with a 90-day Money Back Guarantee.

* One year free update

You can enjoy free update one year. 24x7 online support.

* Trusted by Millions

We currently serve more than 30,000,000 customers.

* Shop Securely

All transactions are protected by VeriSign!

100% Pass Your SY0-701 Exam with Our Prep Materials Via below:

<https://www.certleader.com/SY0-701-dumps.html>